

Release Handle extended to improve accessibility when using fenders.
Option is available with all mounting configurations.

Extended Handle		
JOST Order Number*	Topplate Style	Weight
JSK 37001	Standard L.H. Release	242 lbs.
JSK 37002	Low Lube L.H. Release	244 lbs.
JSK 37003	Holland™ Replacement Topplate	242 lbs.

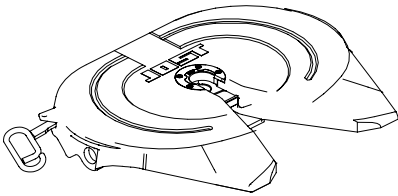

Adjustment Screw located under the Topplate to hide from view and avoid Kingpin damage when a miscouple occurs.

Option is available with all mounting configurations.

Internal Adjustment		
JOST Order Number*	Topplate Style	Weight
JSK 37015	Standard L.H. Release	240 lbs.
JSK 37020	Standard Air Release	246 lbs.
JSK 37017	Holland™ Replacement Topplate	240 lbs.

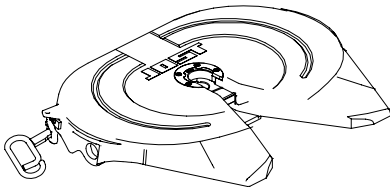

Release handle lowered and Adjustment Screw located under the Topplate to avoid Kingpin damage when a miscouple occurs.

Option is only available with stationary mounts above 6" high (see page 29).

Drop Handle & Internal Adjustment		
JOST Order Number*	Topplate Style	Weight
JSK 37010	Standard L.H. Release	240 lbs.

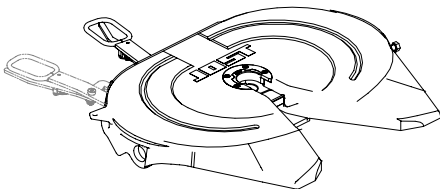

Release handle located in the front of the fifth wheel.

Option is only available with stationary mounts above 6" high (see page 29).

Front Release		
JOST Order Number*	Topplate Style	Weight
JSK 37009	Auto Lube	240 lbs.
JSK 37012	Standard	246 lbs.
JSK 37013	Low Lube	242 lbs.

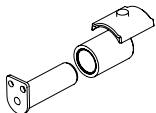

*Pins, bushings & collars not included when ordering the topplate only.

*Order numbers listed are for topplate assemblies only. To order fifth wheel assemblies add the desired mounting configuration number to the end of the topplate assembly (Example: JSK 37001-A7PX24).