

PARTS LIST

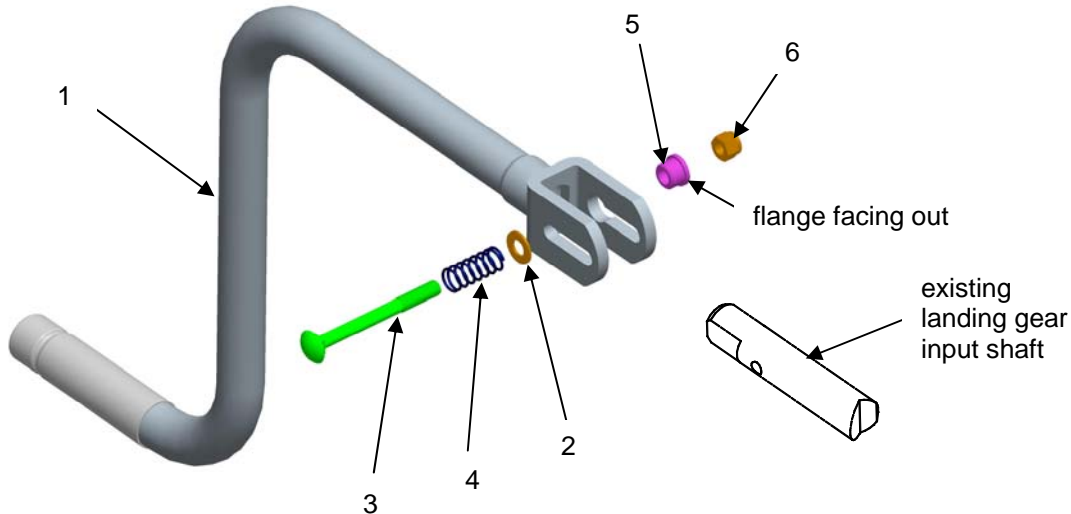

Item	Description	Part No.	Item	Description	Part No.
1	Latching crank handle	11959	4	Compression spring	11955
2	3/8" flat washer	10258.1	5	3/8"-16 Flange nut	11957
3	3/8"-16 x 3-3/4 carriage bolt	11956	6	3/8"-16 Nylock nut	11962

REPLACEMENT INSTRUCTIONS

1. Remove and discard the existing crank and attachment hardware.
2. Align the hole in the input shaft with the slot in the new crank. Now, slide the crank onto the shaft (see Figure 1).
3. Slide the compression spring over the carriage bolt. Next, slide the 3/8" flat washer onto the carriage bolt. (see Figure 2).

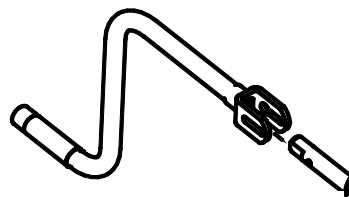

FIGURE 1

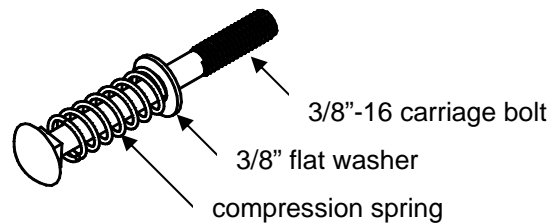

FIGURE 2

REPLACEMENT INSTRUCTIONS CONT...

4. Insert the carriage bolt through the plain slotted side of the clevis, through the input shaft, and out the opposite side of the clevis.
5. Thread the flange nut onto the carriage bolt with the flange away from the clevis (see Figure 1). Tighten the flange nut until it bottoms out against the shoulder of the carriage bolt.
6. Install the Nylock nut onto the carriage bolt. Tighten the Nylock nut against the flange nut to 15 ft-lbs of torque. If needed, push the spring away from the head of the carriage bolt and place an open end wrench on the square portion of the head on the carriage bolt to achieve the proper torque.

OPERATING INSTRUCTIONS

1. To latch into the cranking position, raise the crank handle into the operating position and push inward on the crank until the handle latches securely onto the landing gear input shaft (see Figure 3).

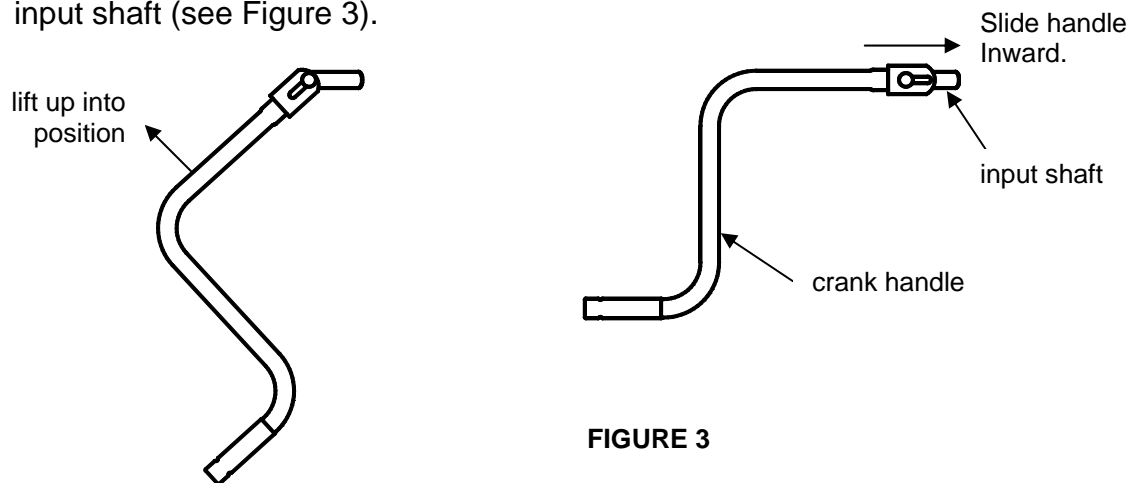

FIGURE 3

2. To release the latching crank, simply push on the rounded end of the carriage bolt until the flange nut is clear. Then, pull the crank outward and stow the handle in the usual manner (see Figure 4).

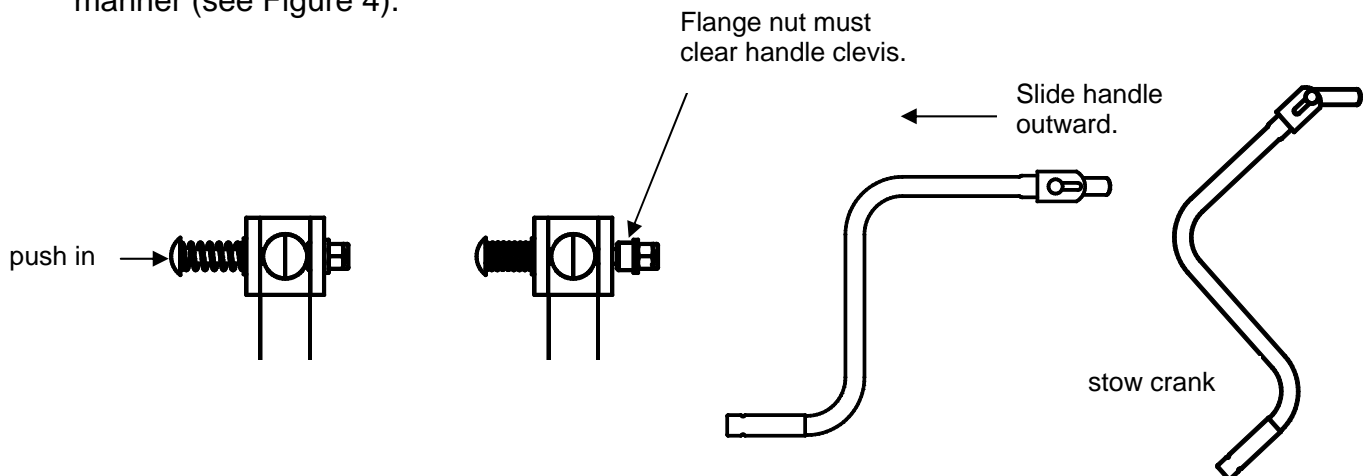

FIGURE 4