

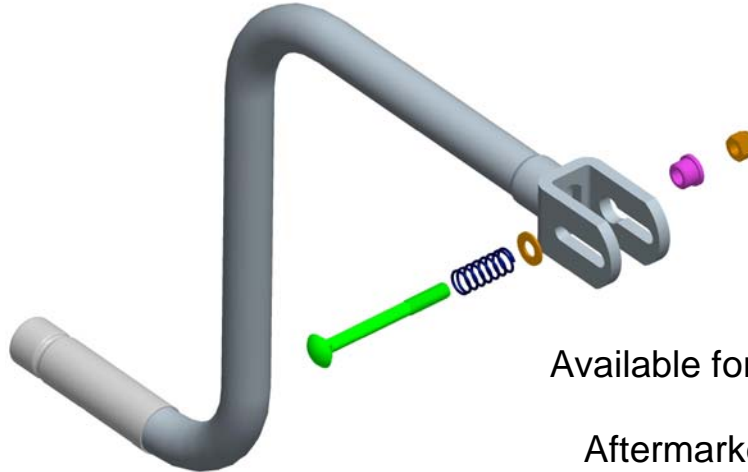

Just announces a new latching landing gear crank handle designed for the A400 landing gear

When moved to the operating position, the crank locks onto the input shaft making shifting and cranking easier.



See operating instructions over

Available for OEM installation or Aftermarket replacement.

Feature:

Benefit:

- | | |
|--|--|
| <ol style="list-style-type: none"> 1. Positively locks crank onto input shaft. 2. Stiffer connection between input shaft and crank. 3. Easy release of locking mechanism. | <ol style="list-style-type: none"> 1. Crank can not slip off accidentally or during shifting. 2. Easier to transmit torque to input shaft without crank wobble. 3. Anyone can operate without instructions. |
|--|--|

How to order:

Request Jost landing gear crank part #11961.X

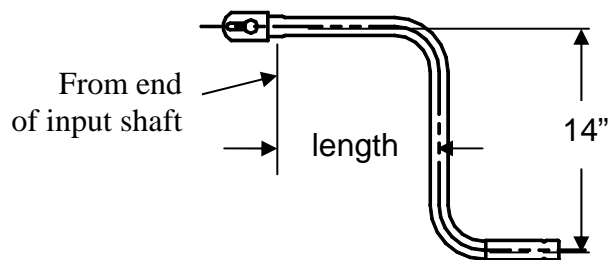

Example: **11961.2**

- Length**
- 1 – 5-1/4"
 - Standard → 2 – 8-1/4"
 - 3 – 10-1/2"
 - 4 – 17-3/4"
 - 5 – 14-3/4"

OPERATING INSTRUCTIONS

1. To latch into the cranking position, raise the crank handle into the operating position and push inward on the crank until the handle latches securely onto the landing gear input shaft (see Figure 3).

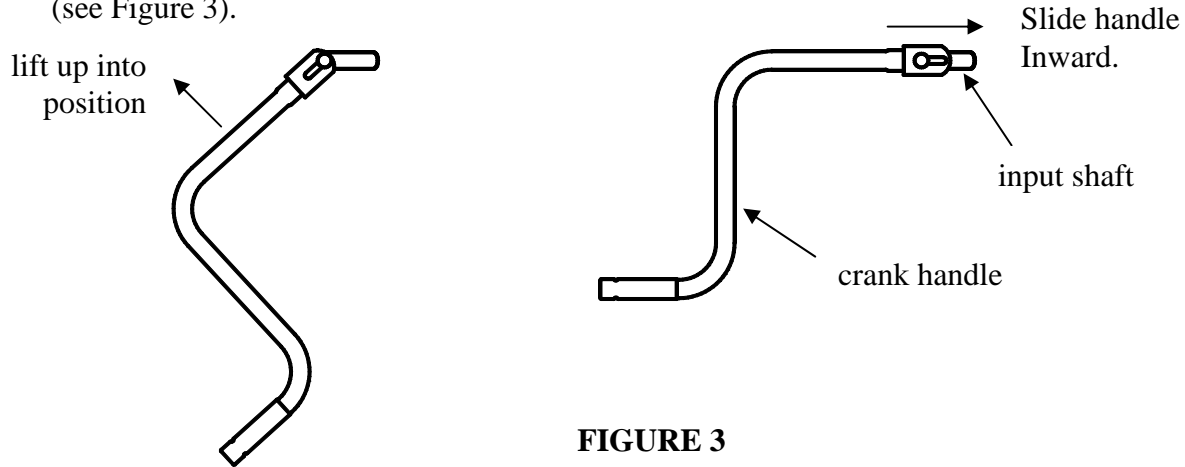

2. To release the latching crank, simply push on the rounded end of the carriage bolt until the flange nut is clear. Then, pull the crank outward and stow the handle in the usual manner (see Figure 4).

